

Setup - How to set up your Ergo Know-Me laptop stand

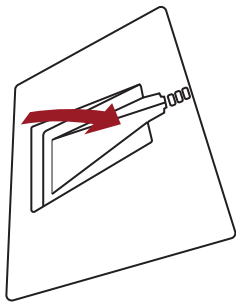

1. Push document holder **support**.

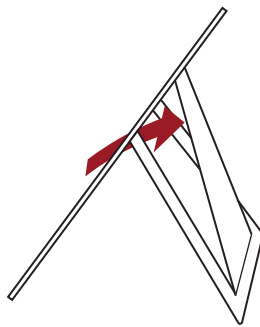

2. Unfold internal **rear support leg**.

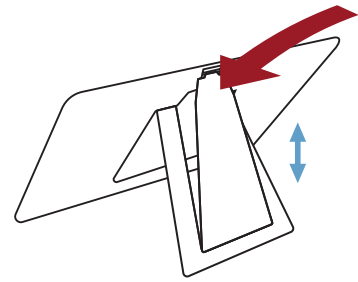

3. Select the appropriate **angle** setting.

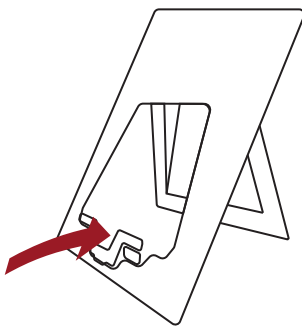

4. Pull out **front laptop support**.

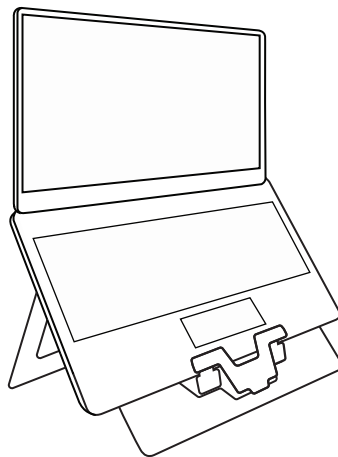

5. Place laptop on stand.

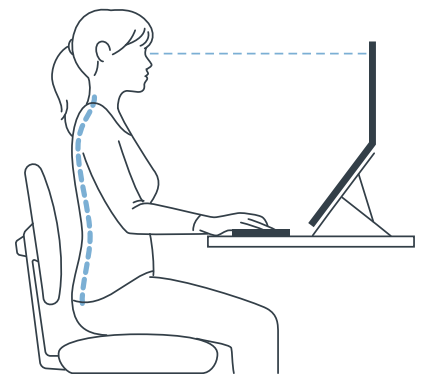

6. Position your laptop about an arm's length away. Add an external keyboard and mouse to create an ergonomic workstation.